

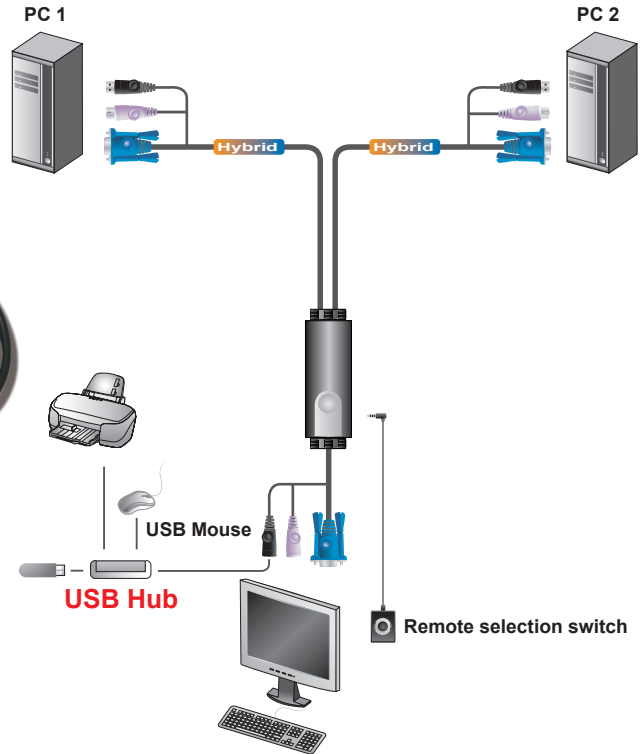

## 2-Port Hybrid KVM Switch

### Diagram

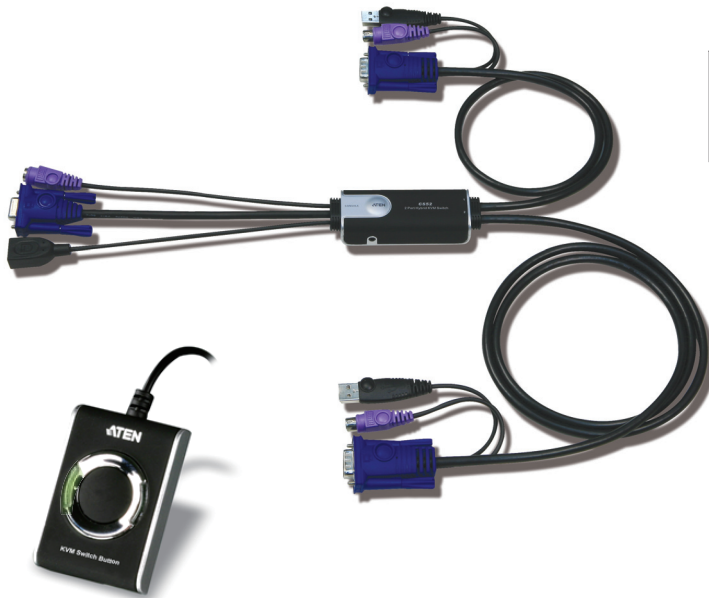

Console PS/2, USB	Computers PS/2, USB	OS Support Win, Linux, FreeBSD	 Non-Powered
 Multi-function mice	<b>NEW OS Support</b> Vista		

### Features

- One console (monitor, PS/2 keyboard, and USB mouse) controls two computers
- Remote port selection switch for convenient switch placement
- Supports multi-function mice
- USB 2.0 connector for USB peripheral sharing
- Compact design, built in all-in-one cables (console 0.15m; computers 0.6m, 1.2m)
- Superior video quality- up to 2048 x 1536; DDC2B
- Auto Scan function to monitor computer operation
- Non-powered

### Specifications

Function		CS52
Computer Connections		2
Port Selection		Hotkey, Pushbutton
Connectors	Console Ports	Keyboard 1 x 6-pin Mini-DIN Female (Purple) Video 1 x HDB-15 Female (Blue) Mouse 1 x USB Type A Female (Black)
	KVM Ports	Keyboard 2 x 6-pin Mini-DIN Male (Purple) Video 2 x HDB-15 Male (Blue) Mouse 2 x USB Type A Male (Black)
	Remote Switch	1 x Mini Stereo Jack
	Switches	Port 1 x Pushbutton
	LEDs	Selected 2 (Green)
Cable	Console	0.15m
Length	Computers	0.6m, 1.2m
Emulation	Keyboard	PS/2
Video		2048 x 1536; DDC2B
Scan Interval		3, 5, 10, 20 Seconds
Environment	Operating Temp.	0-50 °C
	Storage Temp.	-20-60 °C
	Humidity	0 - 80% RH, Non-condensing
Physical Properties	Housing	Plastic
	Weight	0.33 kg
	Dimensions (L x W x H)	8.45 x 3.40 x 2.13 cm

\* The specifications and pictures are subject to change without notice.